



EXPERIENCE
the
DIFFERENCE

EXPERIENCE THE
DIFFERENCE OUR
NEW DISPLAYS
WILL MAKE IN
YOUR SHOWROOM!

- *Sales-generating displays demand immediate consumer attention*
- *Showcase entire line of beautiful Graber window treatments and drapery hardware*
- *Choice of 10 ft. In-Line Display, Free Standing "X" Display or Free Standing "Y" Display*
- *Gain new business with Graber's Display Program*



10 FT. IN-LINE
DISPLAY
71-9900-05

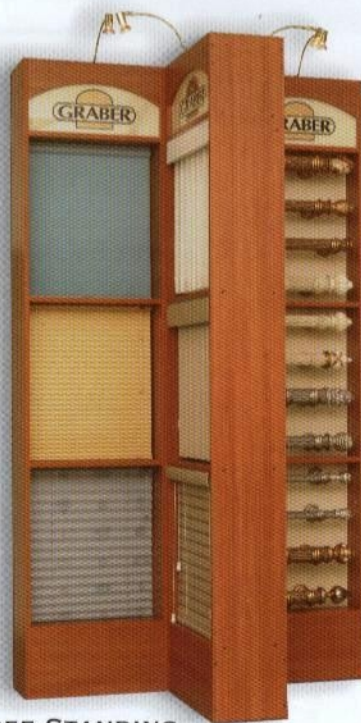

FREE STANDING
"X" DISPLAY
71-9900-06



FREE STANDING
"Y" DISPLAY
71-9900-07



Get Space Ready for Your New Display Today!

- *All displays come complete with your choice of product samples*
- *Receive sample updates for up to one year*
- *FREE shipping and installation*
- *See your fabricator for payment plan*



BEST EXPERIENCE™ DISPLAY PROGRAM HELPS YOU GAIN NEW BUSINESS!

Three great displays showcase all of your Graber window treatments, including drapery hardware!

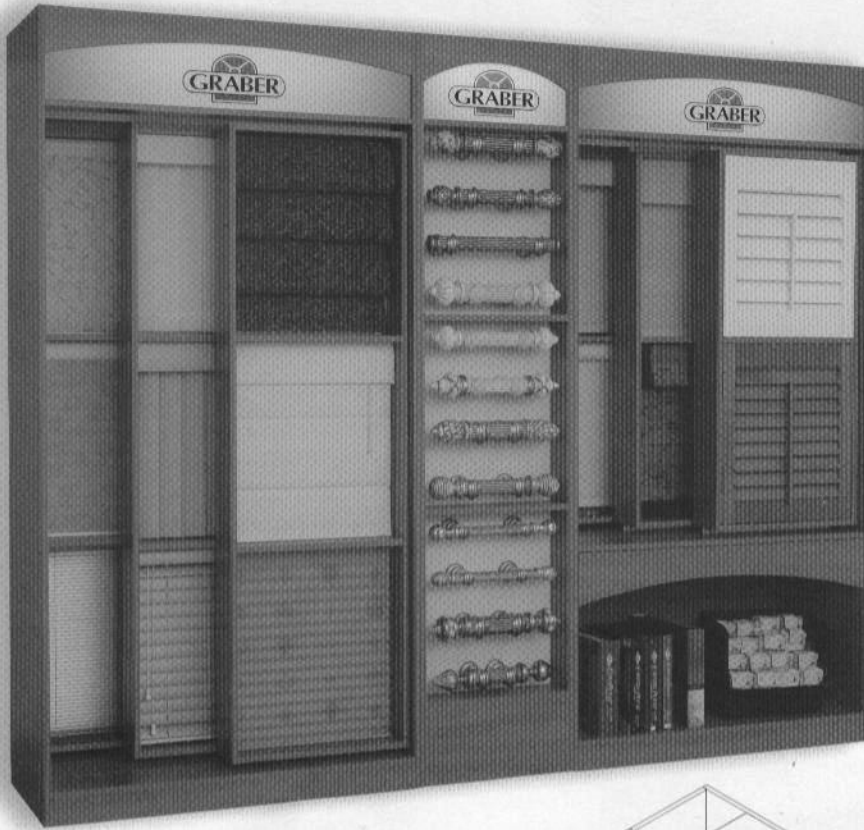

10 FT. IN-LINE DISPLAY 71-9900-05

- Includes samples, shipping and installation
- Slider walls allow for up to 23 sample options
- 10 ft. long x 2 ft. deep x 94" high
- All window openings are 22" x 25" inside mount
- Comes in three sections: 4 ft., 2 ft., 4 ft.
- Includes storage space for Graber sample books
- Includes pull-out drawer for Graber selectors and literature
- Includes three back panels for drapery hardware
- Includes backlit gold Graber logo at top of display

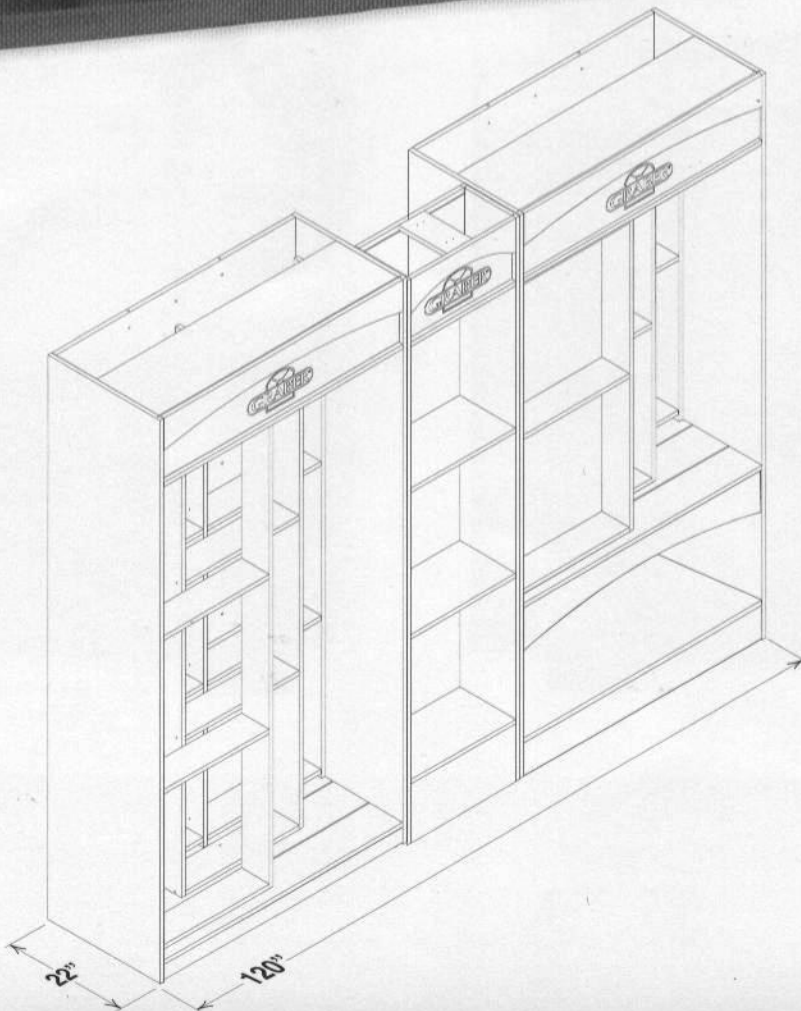

HELPFUL HINTS:

- Plan how you will run power to the lights before you place units against wall.
- If possible, choose a level location for fixture.

ALL DISPLAYS INCLUDE

- Beautiful natural Cherry Wood finish
- Signage Option – Includes product identifiers for each window box (i.e. Graber (logo) CrystalPleat® Cellular Shades) with room to add in the color name and number of actual product displayed

